



## INDOOR COVID-19 POLICIES & PROCEDURES

### WSF SOCCER SOUTH & WSF SOCCER NORTH

All users of our facilities must review the policies and procedures contained within this information package. It is the league and team representative's responsibility to distribute this information to all participants and ensure they understand and will adhere to these policies and procedures. If your group requires assistance, please contact the Winnipeg Soccer Federation in advance of your rental date to discuss how we can assist you.

#### **MASKS ARE MANTORY AT THE FACILITY. ALL PATRONS ARE RESPONSIBLE TO SUPPLY THEIR OWN MASKS.**

- Masks must be worn by players, team officials, and referees before and after games. It is optional to wear the masks during play.
- All spectators must wear masks for the full duration of time they are inside the facilities.
- If you are unable to wear a mask for medical reasons, please contact your league representative so they can advise facility staff in advance.
- Masks are available to purchase for \$1 at the Information Booth.

#### **COVID-19 PROCEDURE OVERVIEW**

- **FIELD ENTER/EXIT PROCEDURES:** Please review the attached information and field level maps to learn the procedures for proceeding to and from the fields and where your team waiting areas are.
- **SPECTATORS:** Spectators are not allowed for adult games. For youth games, one spectator per player is allowed and must go directly to the concourse level upon arrival at the facility (no field level access). If you need to assist your child, please do so on the concourse level before they proceed to their assigned field.
- **NO CHANGE ROOMS:** All participants are to arrive dressed to play (indoor shoes changed on-site). Designated dressing rooms will be available for washroom purposes only. No changing or showering in these rooms.
- **FIELD PHYSICAL DISTANCING AREAS:** Blue dots are located at the sidelines of the fields. Players are to place all personal items on a dot and this is your area for the duration of the game. When not in the game, players are to stand by their bag in their area to maintain a physical distance from each other. Benches may be used as rest areas. These areas will be disinfected between games.
- **HAND SANITIZER:** Pumps are available at the facilities. Everyone must also bring their own for personal use.
- **DISINFECTING PROCEDURES:** Areas of the field (benches and surrounding area, flags and nets) will be disinfected between every game. Additional cleaning will also be done in the washroom and concourse areas.
- **FACILITY PHYSICAL DISTANCING:** Physical distancing is to be practiced in all areas of the facility at all times, including the team waiting areas, seating areas, main foyer and concourse level.
- **POLICIES & PROCEDURES:** All policies and procedures set forth by the Province of Manitoba, Winnipeg Soccer Federation and your associate league must be followed at all times. Failure to do so may result in your removal from the facility.

**REVIEW THE PROVINCE OF MANITOBA'S COVID-19 PRE-SCREENING TOOL PRIOR TO ARRIVING AT THE FACILITY. IF YOU HAVE SYMPTOMS, DO NOT ENTER THE FACILITY AND START FOLLOWING COVID-19 PROCEDURES IMMEDIATELY.**



Updated as of October 19, 2020

## INDOOR FACILITY GAME PROCEDURES

### WSF SOCCER SOUTH & WSF SOCCER NORTH

**REVIEW THE PROVINCE OF MANITOBA'S COVID-19 PRE-SCREENING TOOL PRIOR TO OR UPON ARRIVAL AT THE FACILITY. IF YOU HAVE ANY SYMPTOMS, DO NOT ENTER THE FACILITY AND START FOLLOWING COVID-19 PROCEDURES IMMEDIATELY.**

The Winnipeg Soccer Federation is committed to providing a healthy sports environment. Our indoor facilities are over five stories high and are equipped with extensive ventilation systems that provide fresh air into the buildings. Our systems remove air from the buildings and provide fresh air every 20-30 minutes. Air quality testing has shown readings for ambient air quality equivalent to outdoor fresh air standards.

The WSF have also set new policies and procedures in place to provide the opportunity to play safely and physical distance as much as possible. These include wearing masks, having designated entrances and exits for the facilities and fields, additional hand sanitizer stations and increased disinfecting and cleaning practices. WSF staff are on-hand throughout the facility to provide guidance and answer questions.

#### **MASKS ARE MANDATORY AT THE FACILITY. ALL PATRONS ARE RESPONSIBLE FOR SUPPLYING THEIR OWN MASKS.**

Masks must be worn by players, team officials and referees before and after games. It is optional to wear masks during play. All spectators must wear masks for the full duration of time they are inside the facility. If needed, masks are available to purchase for \$1 at the Information Booth. If you are unable to wear a mask for medical reasons, please contact your league representative so they can advise facility staff in advance.

#### **GAME PROCEDURES**

##### **PRE-GAME PROCEDURES**

- Review the attached field level maps for the south and north facilities to acquaint yourself with where you are to go once you arrive at the facility.
- Be dressed to play before departing for the facility. If possible, change into your playing shoes once inside the facility.
- Arrive within 15 minutes of your game start time. There will be no field level access prior to this time.
- Proceed directly to your team waiting area beside your assigned playing field. **Do not remove your mask and spread out as much as possible to adhere to physical distancing guidelines.**
- Select dressing rooms will be available to use for washroom purposes only. No changing or showering will be allowed.
- **YOUTH PLAYERS:** If needed, you may meet your coach on the concourse level and proceed to the playing field as a group. Parents and spectators are not allowed at field level.
- Do not enter your assigned field until the WSF staff have finished the disinfecting process and give clearance to proceed.
- Once on the field, locate a **BLUE DOT** on the sidelines and place all personal items there. This is your area for the duration of the game. When not playing, players stand by their bag to maintain a physical distance from team members. Benches may be used as rest areas. Please do not bring valuables into the facility. The WSF is not responsible for lost or stolen items.
- Players, team officials and referees may remove their mask during the game while on the field and in technical areas.

##### **POST-GAME PROCEDURES**

- **Put your mask back on before departing the bench area.**
- Time is limited between games so do not linger. Quickly change into your outdoor attire and collect your belongings.
- Proceed quickly to your designated field exit, proceed up to the concourse through your designated field level door and then continue out the main doors of the facility to exit.
- All players and spectators are to exit as quickly as possible. Do not congregate on the concourse or at the exit areas.
- **YOUTH PLAYERS:** Parents are to arrange to meet their children on the concourse level after the game. There will be no loitering allowed at the main entrances/exits of the facilities.

Adjustments may be made to procedures. Follow the guidance of the WSF staff and adhere to the signs posted at the facilities. All policies set by the Province of Manitoba must be followed at all times. .



# WSF SOCCER SOUTH FIELD LEVEL PROCEDURES (PIT)

Updated as of October 19, 2020

Location: 211 Chancellor Matheson Road (University of MB Campus)

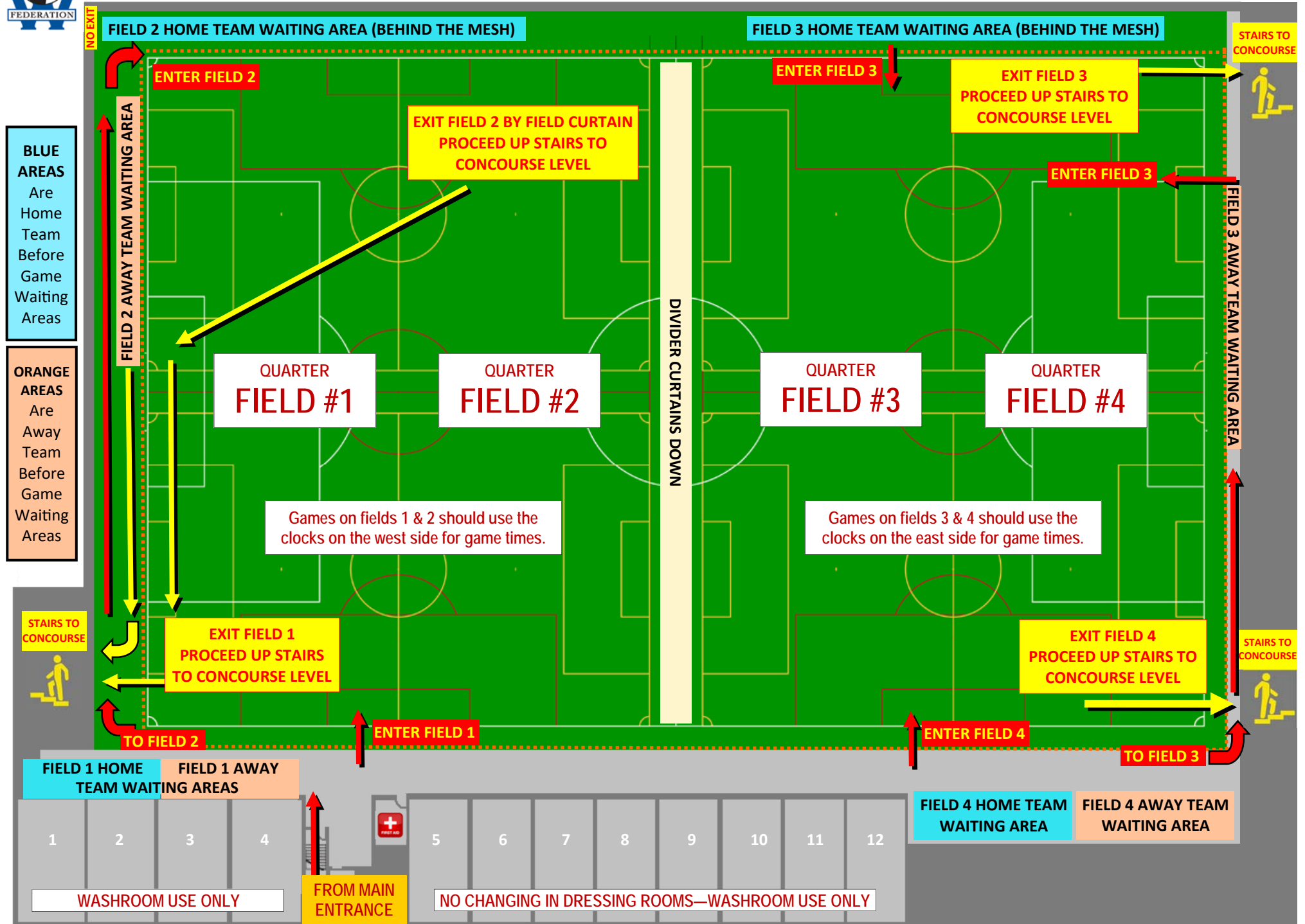



# WSF SOCCER NORTH FIELD LEVEL PROCEDURES (PIT)

Location: 770 Leila Avenue (Garden City)

Updated as of October 19, 2020

